

Th left France Arrived Niger

- Fr 28th Met with MLU, MA:
directeur de l'urbanisme et de l'habitat, M Aboubacar Hamidou BP 669 NY, tel 723600 poste 3311,
- Entrepreneur, Aboulrakman Sanan ent SINAD BP 214 Agadez tel 440497, NY BP 11495 tel 740526 introduced to Mouloul / JN/ IUCN OFFICE
- Elhaji Abou ALI Architect, Chef de service Central de l'habitat tel 72 36 00 poste 3343 talked about:

- him spending time on the Filingue Stage, meeting arranged at RF site
- site visit tp arch at RF site subject runoff towards road
- Elhadj is preparing a dossier for the reconstruction of Bazagara ?? to be in CSB needs our advice I asked that he ask us formally

RF

RF

- RF directeur
He accepted modular notion / outline concept, pleased and excited he asked that **we request /specify funding installments so he can go ahead**

- USAID Meeting
- SNP meeting

NT

- Niger T ip Dossier problem. plans contain significant errors

Sa

Siddo

- simple menuiserie nearly ready but inappropriate welding used I asked for completion and new set of "app tools version"
- can provide us with a trainer
- siddo operates under the name of an older brother who is a tacheron agrée (sp) and discussion exposed that
- they had just built a school classroom in semi dur and can provide costing/quantities
- he would look into details of brick provision logistics/costing for RF
- visited RF site with Siddo, impressive thinking from Siddo
- Idea developed of Siddo co-ordinating a team of our best Artisans to construct RF possibly a direct contraction with his Tacheron group, it seemed that this offers significant advantages like dealing with legal aspects eg labour laws, Modular concept appealed to him
- SiDDO to come to IUCN on Sunday
- Located Abdou Shekerou's house asked that he come to IUCN on Sunday with electrician and plumber

Su :

- Worked on RF dossier No show fro siddo or Abdou me too busy to go looking
- IUCN meeting left for tapoua met various people but significantly

Olivier

Senegal chef, N'diai ?

Ibrahim Thiaw

Money poss available for Senegal work, poss' building in Diouf

left nNy fo Fil' with JN, DM, Ali

Mo - Objectives,

T of T (FP's)

nem

w guide /strategy 3 -5 changed to 2 -3 -1-2

Stage Knot tying dramatically made me aware of difficulties in communicating techniques, I had real problems learning JN's bowline method but MA didn't. Me with prefixed ideas? emphasis emerged on 3 stages

- Demo where trainer/trainee stand in relation to each other
- Practice
- testing/verification

Excellent meeting on site with mayor

Tu - Arches JN stress on the fact that they are being problematic. resolution sharp curvature needs To be built with Small(roof) bricks: smaller mortar wedges, lighter, easier to trim, large curvature big briques ok

personal reflection, flatter door arches could be fine with big bricks being rounder weakens them verticality/horizontality, noted that bonding F needs to be combined with F5

MLU french session with Malians revealed that square and rectangle are just words not geometric definitions

Action needed

multi lingual VOCAB list plus check on definition of word
drawings fixed and put on stage house wall
drawings for initial fiches

We : Niger T ip visit from Architecte ---- & technicien----- long initial discussion in Tunfliz villa
both men impressive particularly technician excellent questions but they thought that bTS
can be built with same method and masons as Banco
solves all maintenance problems

My main point we could **not** provide designs or masons for BTS work . but we could provide design
help/masons if its in Banco

Architect receptive but naive thinking that they had climatic design elements figured out for bts D&vs
PT briefs JN over lunch

After lunch session with JN JN gave the party line
result of their reflection on our commentary they:

go away and rethink the spacial/functional layout into 3 independant modules
come back to us for roof detailing + any spacial changes demanded by the roofing
meet JN in NY on monday

STAGE

f- cobined to f because of order problem

DAN observed that

the st's doing too much menial/repetative work - long discussion JN PT DM resulting in
notion of three teams composed of A B C D and that a given teaching element (fiche or prt of)

A demonstrates to B C D

B trains C

A & D critique B & C

for next "element cycle starts with B and so on

remblage text needs dia change on f5? drawing caused excellent discussion session with st's it looked
like we were asking for a 40 CM horizontal pendentive start

book needs additional points on rebalais.

St's discussing their working? hours our reaction will be they have no Hours they have the luxury of
being taught to learn

labour 8hrs containing half hour break

38,24,12, brick accepted by masons for our own work eg for RID FIT

BRAINSTORM WE 12

Excellent meeting with TOM and MLU Idea of using perceived information/research needs to focus

MLU study Energy II Pierre ? + winterbotom + 1 given as contacts

BETAS

meeting IUCN NY they presented new modular plans i commented see drg

Meeting IUCN 09/11 with Magass resolved

letter to director him laying out mature of collaboration with CSB

latest plns to us this evening

them to filingue in next few days to review plans/ meet a work crew Karimou?

met with Marrima et Iro socially but worked on NIN DISP ideas Marriama the user was very usefull
resulting in clearer definition of functional needs

THURS 10th

Yrf tecnicien Idrissa Amadou started work,, i left him in NY to work up RIDFIT finishings DEVIS
quantitative. Introduced him Tom ,Abdou Shekarou ,RIDFIT Directeur, early days but impressive

I asked for specs on plumbing, electric's painting, tiling etc. started to address the clay/brick
production problem made on site or not which clay etc etc but me to solve that with him + ???

Siddo. The existance of IA reduces potentially the need for Siddo/Abdou Shekarous involvement

betas I called in at their office with IA saw latest version of plans they absorbed pretty well all the
advice excellent the building starts to be realistic. I asked that they swiftly ,24 hrs , go to sections
so that i can teach/guide them on details

agreed to try and fix them up with masons for starting as our team goes to Myriah

visited NINDISP on way to filingue lots of new details from NIN rep Namata + very +ive reaction to
new plan from Major

in Filingue st had advanced well excitement/ misunderstandings created by mud hemisphere
chopping . Great potential teaching and design potential exposed Jason to write up

Sa

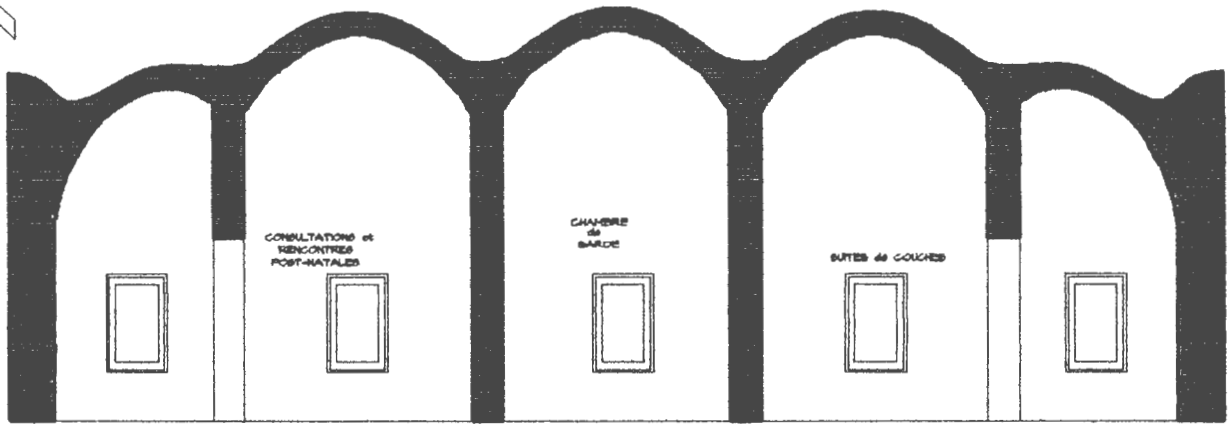

COUPE CC

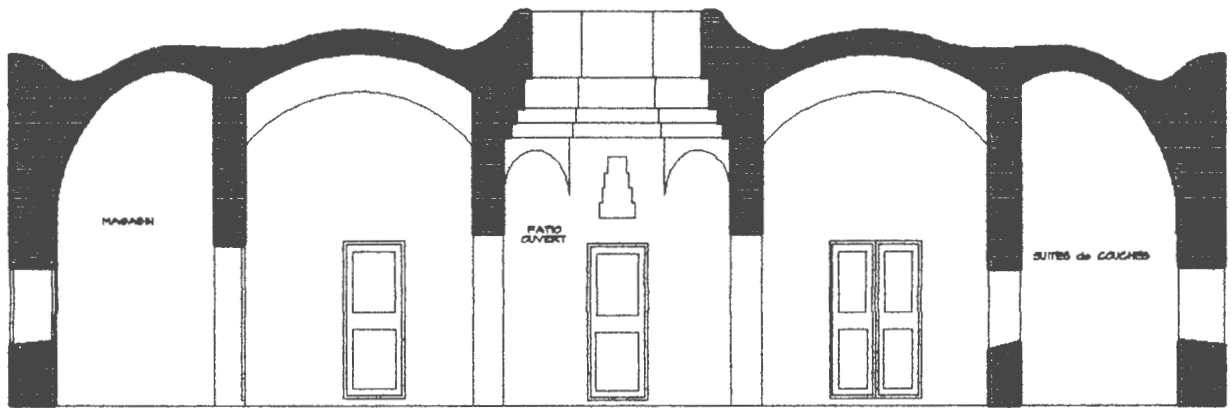

COUPE BB



COUPE AA

MATERNITE DE BONKOUKOU

PROPOSITION DE REAMENAGEMENT
BATIMENT "A"

DEVELOPMENT WORKSHOP
BP 13, 82100 LAUZERTE, FRANCE
TEL (33) 63950234 FAX (33) 63948242

CLIENT	NINAFRI		
LIEU	BONKOUKOU		
DESSIN #	COUPES		
DESSIN PAR	PT ET AL		
ECH	1:100	DATE	12/11/94



Schéma de ventilation transversale

puits de ventilation ouvrable dans le toit, avec pomelles sur le côté est: ouvert, il permet une ventilation à l'aide de la convection et l'effet "Venturi" (particulièrement important la nuit); fermé, il assure une bonne protection du froid, de la pluie et de la poussière; il donne également davantage de lumière pendant les dernières heures de travail le soir.

murs protégées du soleil par des auvents et qui restent donc à l'ombre le plus possible

fenêtre en verre, protégée du soleil par un auvent, grâce à laquelle la pièce est illuminée, sans laisser pénétrer une lumière excessive ni les rayons directs du soleil

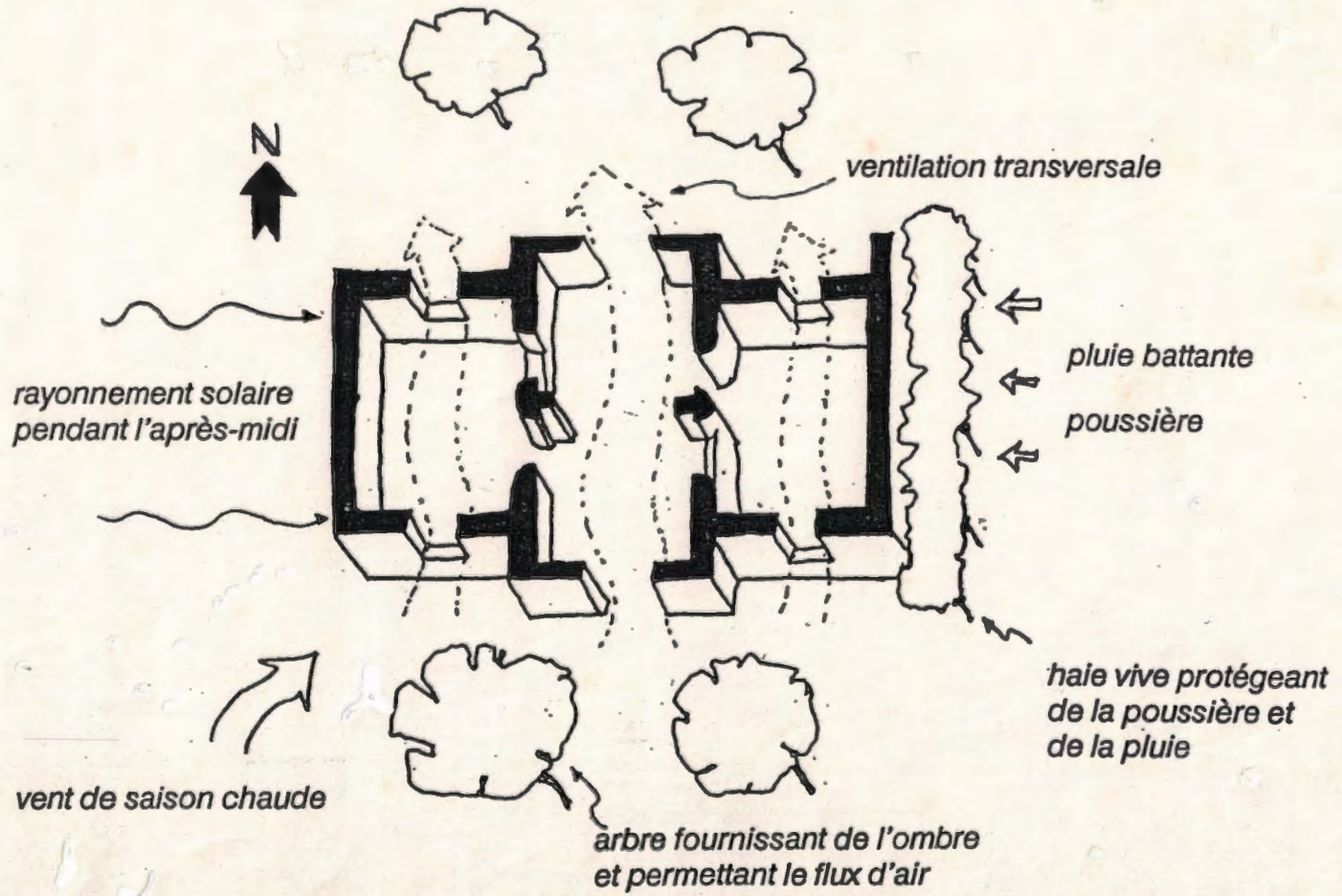
portes protégées du soleil par des auvents et qui restent donc à l'ombre le plus possible

persienne orientable dans la partie basse des portes permettant aux courants d'air plus frais de la cour intérieure de rafraîchir les occupants; au besoin, une plaque unie peut être fixée pour empêcher la poussière de pénétrer

double fenêtre: l'une en verre, ouvrable vers l'extérieur pour conserver le maximum d'espace utilisable dans la pièce et sur les murs; l'autre, persienne orientable de façon à ce que les courants d'air soient dirigés au-dessus des tables, mais à hauteur du corps des occupants. L'ensemble assure une bonne protection contre les voleurs, la pluie, la poussière, les vents forts, et une luminosité excessive.

